

PRESSURE REDUCER VALVE MODEL: TR-PRV_2
BIBNOSE VALVE

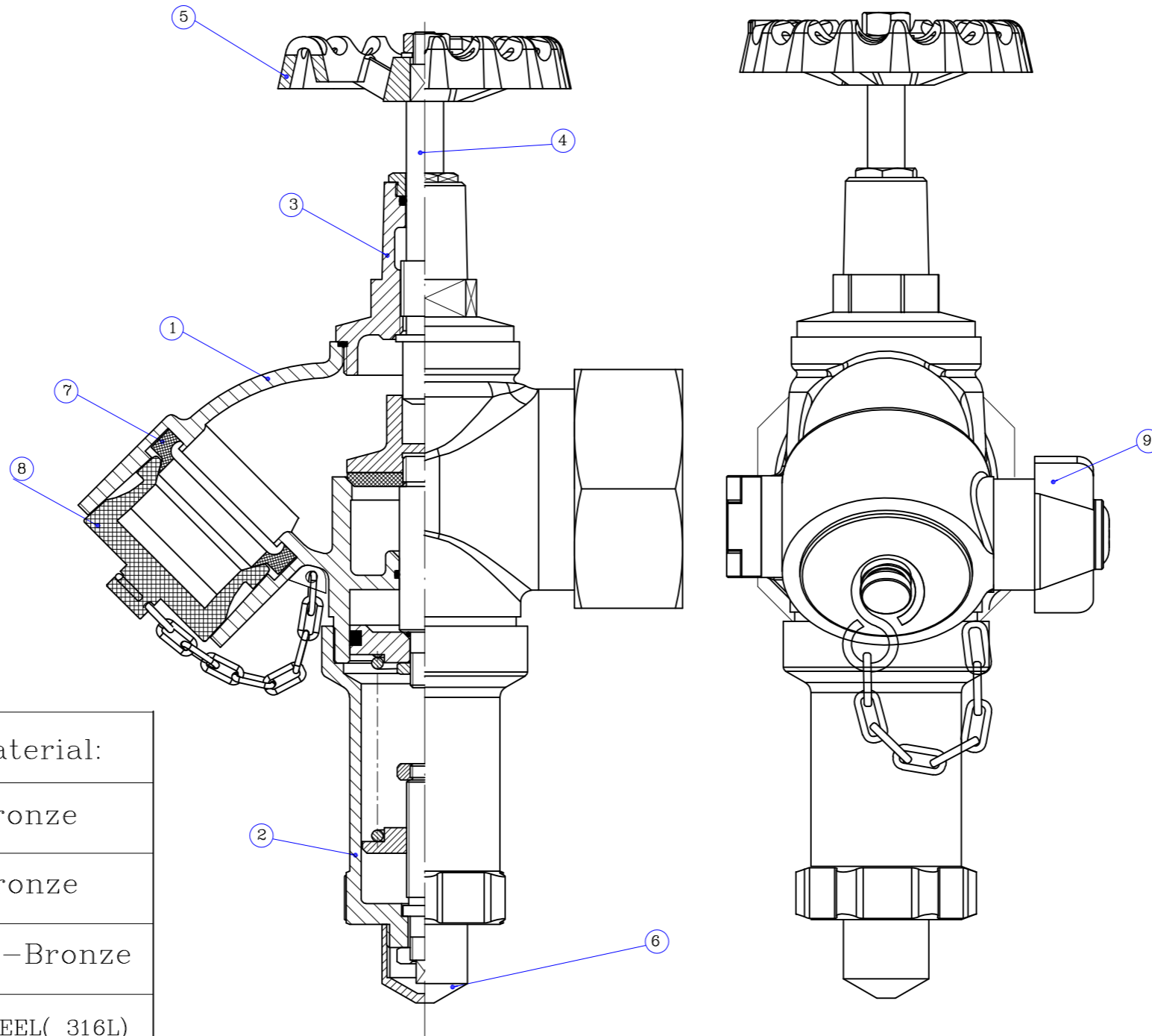
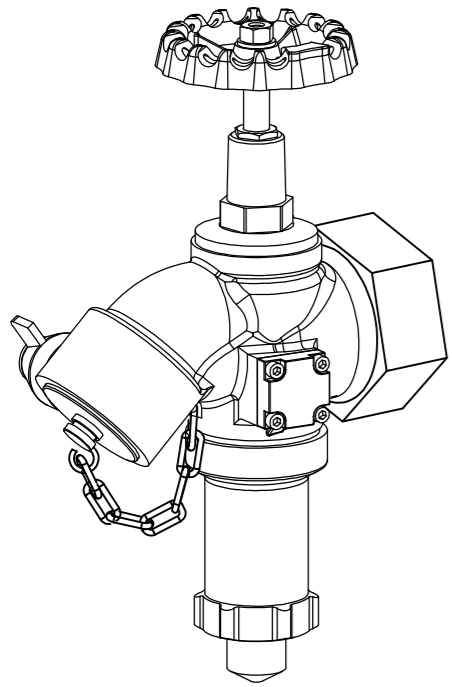

TEST PRESSURE : 21 BAR
NORMAL PRESSURE : 7 BAR
INLET CONNECTION : 2 1/2" 8NPT

NO.	QYT.	Part Name:	Material:
1	1	Body	Bronze
2	1	Regulator Cup	Bronze
3	1	Bonnet	Al-Bronze
4	1	Upper Stem	S.STEEL(316L)
5	1	Hand Wheel	Cast Iron
6	1	Protective Bonnet	Brass(MS58)
7	1	CW Washer	N.B.R
8	1	2 1/2" Cap	Bronze
9	1	Release Plunger	Brass(MS58)
10	1	chain	s.steel

WEIGHT: 12 kG
QUANTITY: 80 Units

PAINING:(for Globe valve)
FIRST LAYER WASH PRIMER
INTER MEDIATE LAYER EPOXY
TOP COATED Polyurethane (RAL 3001)

PAINING:(for hand Wheel)
FIRST LAYER Zinc Rich 70Mic
TOP COATED (Black) 50Mic

REV.	DATE	DESCRIPTION	ORIG. BY	PREP. BY	CHKD. BY	APPD. BY	AUTH. BY
02	11/06/13	For Approval	ITE	M.E	Sh.S	H.Kh	B.L
01	06/05/13	For Approval	ITE	M.E	Sh.S	H.Kh	B.L
00	13/03/13	For Review	ITE	M.E	Sh.S	H.Kh	B.L

P.O. No.: AOGC-GEN-PT-PO-8001 STAGE: SCALE:



DRAWING No.: VD-AOGC-DR-GEN-8001-6001 SHEET No. REV. 0